

Wing Union PT

Hammer Lug 2" fig.2202 Pressure Transmitter

- ✓ Ranges from 15000 to 20000psi
- ✓ Total Accuracy < 0.2 % FS
- ✓ Fast response time (2ms)
- ✓ Sputtered Thin-film technology
- ✓ Intrinsically safe; Ex ia
- ✓ Optional Temperature output
- ✓ Use in harsh environments
- ✓ *No mounting effects on signal*



The Wing Union Pressure Transmitter represents the ultimate solution for fast response, high accuracy and long life time performance.

It is an extremely rugged sensor designed for use with the two-inch Hammer Lug in high-pressure applications, in rough and demanding environment for both on- and offshore industry.

Our thin-film strain gauge measuring technology sputtered on our unique semi-flush diaphragm, electron beam welded to a sensor bed, is superior at both dynamic and static measurements for long life time and high pressure applications.

The design and material selection provide durable service with highly abrasive and corrosive media, and comply with international accepted

standards for materials operating in corrosive environments.

The Wing Union by Scan-Sense is digitally calibrated and temperature compensated with an analogue 4-20mA output signal. The transmitter can also be delivered as a dual sensor; with both pressure and temperature output.

Extensive pressure & temperature cycling tests guarantee this pressure transmitter to be the right choice for the Oil and Gas industry.

Typical Applications are:

- ✓ Mud Logging
- ✓ Drilling
- ✓ Cementing
- ✓ Well Logging and Intervention
- ✓ Fracturing
- ✓ Acidizing
- ✓ Choke and Kill
- ✓ Standpipe

Technical information

Pressure Ranges	0-15000 to 20000 psig
Total Accuracy	± 0,2% of Full Scale
Long Term Drift	< ± 0,1% of Full Scale / Year
Output Signal	4 - 20mA (2-wire configuration)
Supply Voltage	10 - 28Vdc
Typical Response Time	< 2ms
Safe Overpressure	≤ 1,5 x Full Scale (or up to 22500psi)
Burst Pressure	> 3 x Full Scale
Ambient Temperature	-20°C to + 80°C
Medium Temperature	-40°C to + 140°C
Storage Temperature	-40°C to + 125°C
Protections	Ingressive Protection IP68 Reverse Polarity
Safety Classifications	CE marking according to EU's EMC directives Atex directive 94/9EC (Dnv): Ex ia IIC T4
Pressure Fitting	2" fig. 2202 Hammer Lug male sub
Electrical Connection	Pressure: Pair 1(blue) / pin C: Supply (+) Pair 1(black) / pin B: Signal (-) Temperature: Pair 2 / pin A+D
Temperature output (optional)	3,85 ohm/°C (PT1000; - 50°C to +300°C)
Weight	3,4 Kg (7,5 lb) without cable
Documentation	Calibration and Ex Certificates

Note: Due to continuous product improvements, published specifications may change without notice.

Ordering details 5WU2202-20

Part no: Range:
5WU2202-20-15-x 0-15000psi
5WU2202-20-20-x 0-20000psi

↑
0= Glenair bulkhead 4 pin
Glenair ref. GC379-2-14S-2P
3= Cable gland with fixed cable
Draka BFOU(i) 250V
- Mud resistant NEK 606 (type: S7)
- Halogen free NEK 606 (type: S3)
- Fire resistant IEC:60331

* Other electrical connectors on request

add PT in end of Part no. for temperature out
- PT1000 - 3,85 ohm/°C

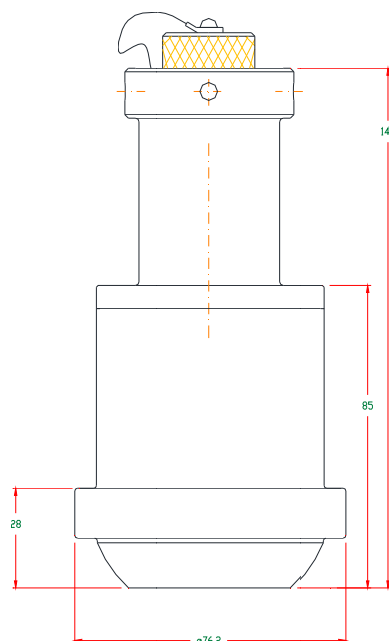

Scan-Sense AS is a Norwegian company specializing in design and manufacturing of high quality sensor solutions for pressure, load and force. The company has more than 28 years of experience of making tailor-made solutions for the oil and gas industry.